

# D-Cell | MAGLITE® FLASHLIGHT

## Specifications

Mouse over part number or illustration for photo of part.



(Without a 'D' in front of serial number)

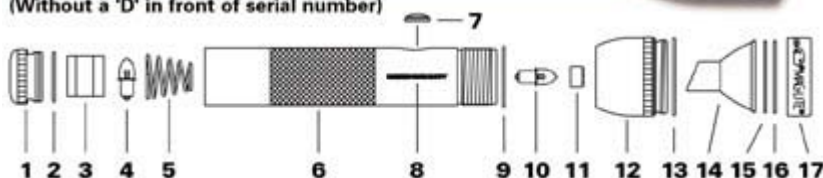

- |   |  |
|---|--|
| <b>1</b> Tail Cap (Part No.200-038)         | <b>10</b> Lamp (See Below)                   |
| <b>2</b> O-ring, tail cap (Part No.108-029) | <b>11</b> Lamp retainer (Part No.200-057)    |
| <b>3</b> Lamp Protector (Part No.108-037)   | <b>12</b> Head (See Below)†                  |
| <b>4</b> Spare Lamp (See Below)             | <b>13</b> O-ring, Head (Part No.108-025)     |
| <b>5</b> Battery Spring (Part No.108-032)   | <b>14</b> Reflector (Part No.108-036)        |
| <b>6</b> Barrel with switch (See Below)     | <b>15</b> Clear Lens (Part No.108-031)       |
| <b>7</b> Switch Seal (Part No.108-034)      | <b>16</b> O-ring, face cap (Part No.108-026) |
| <b>8</b> Serial Number                      | <b>17</b> Face Cap (Part No.201-157)         |
| <b>9</b> O-ring, barrel (Part No.108-027)   |  |

Product Name	Length	Barrel Diameter	Barrel Part No.	Head Diameter	Weight With Batteries	Battery Required	White Star Lamp	Mag-num Star Lamp (Opt.)**
2D-Cell Mag-Lite® Flashlight	10"-254mm	1-9/16"-39.67mm	(see below)†	2-1/4"-57mm	23.8 oz.-674g	(2)D Size Alkaline	LWSA201	LMSA201
3D-Cell Mag-Lite® Flashlight	12-11/32"-313mm	1-1/4"-31.75mm	<b>108-226</b>	2-1/4"-57mm	30.02 oz.-866g	(3)D Size Alkaline	LWSA301	LMSA301
4D-Cell Mag-Lite® Flashlight	14-23/32"-313mm	1-9/16"-39.67mm	(see below)†	2-1/4"-57mm	36.8 oz.-1043g	(4)D Size Alkaline	LWSA401	LMSA401
5D-Cell Mag-Lite® Flashlight	17-1/8"-434mm	1-9/16"-39.67mm	(see below)†	2-1/4"-57mm	43.5 oz.-1233g	(5)D Size Alkaline	LWSA501	LMSA501
6D-Cell Mag-Lite® Flashlight	19-1/2"-495mm	1-9/16"-39.67mm	(see below)†	2-1/4"-57mm	50 oz.-1417g	(6)D Size Alkaline	LWSA601	LMSA601

**ANSI  
DATA  
Coming  
Soon**

† Peak Beam Candlepower is approximate and may vary between flashlights, lamps, and/or batteries. Data presented is for D-cell Mag-Lite® flashlight equipped with a White Star® lamp.      \*No longer available      \*\*Optional, an upgrade Xenon lamp